

3.2 Main technical parameters (30EPCR Electric Pallet Truck)

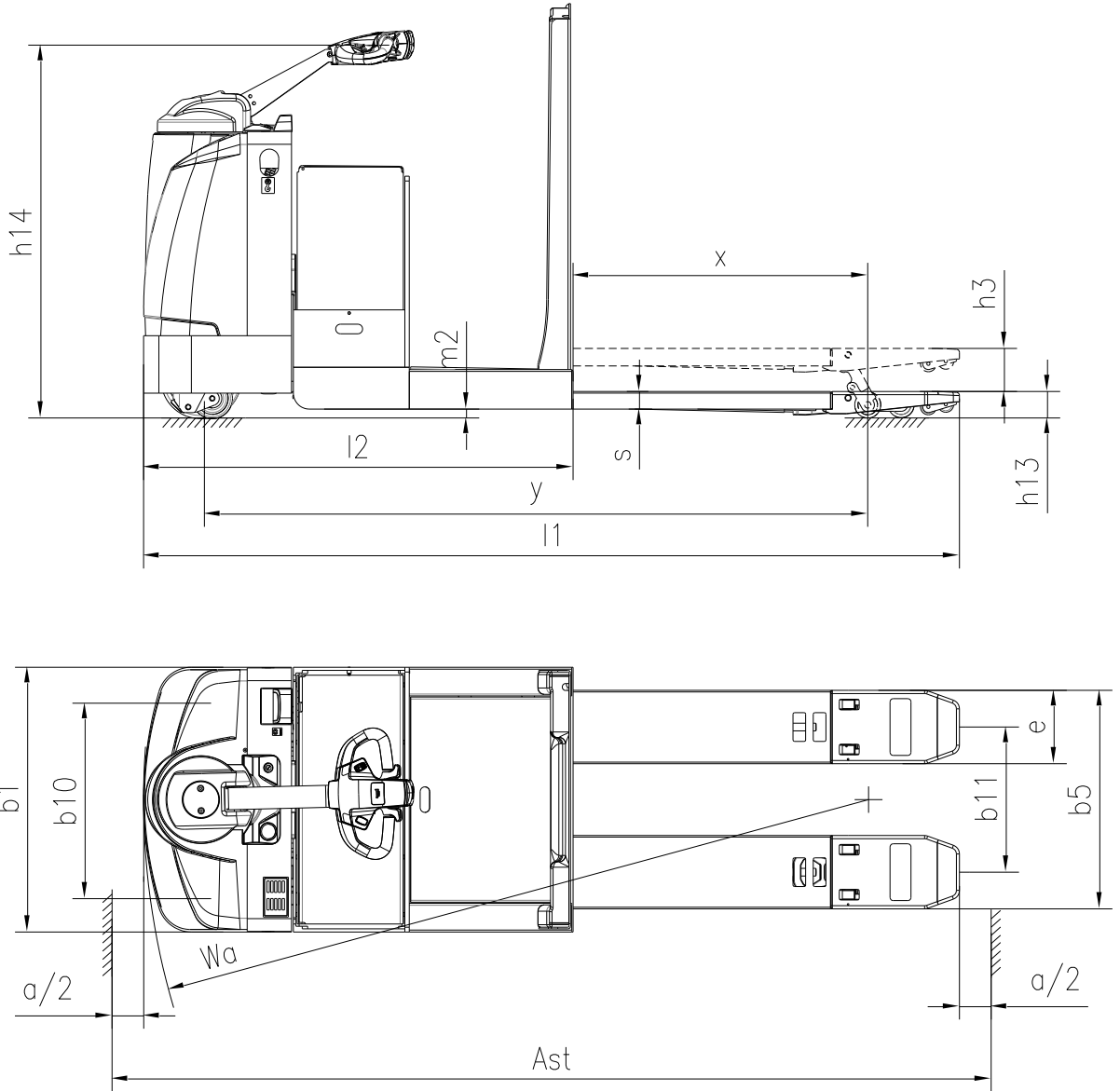

Characteristics	1.1	Manufacturer(abbreviated)		Hyundai
	1.2	Model		30EPCR
	1.3	Driving type		Electric
	1.4	Operating type (Manual, Walking, Stand driving, Seat driving ,Order picking)		Standing
	1.5	Rated load	Q(kg)	3000
	1.6	Load center distance	c(mm)	600
	1.8	Front overhang	x(mm)	1036/933
	1.9	Tread	Y(mm)	2115
	Weight	2.1	Service weight(with battery)	kg
2.2		Axle load, front/rear, laden	kg	1390/2760
2.3		Axle load, front/rear, unladen	kg	860/290
Wheel chassis	3.1	Wheels (rubber, high elasticity, pneumatic tyre, polyurethane wheel)		PU
	3.2	Wheel dimension, front		φ250×80
	3.3	Wheel dimension, rear		φ82×173
	3.4	Additional wheel(dimension)		φ127×57
	3.5	Wheel number, front/rear (x = driving wheel)		1X+2/2
	3.6	Tread, front	b_{10} (mm)	620
	3.7	Tread, rear	b_{11} (mm)	455
Dimension	4.4	Lift height	h_3 (mm)	135
	4.9	Min. /Max. height of operation handle, in driving position.	h_{14} (mm)	1070/1370
	4.15	Height, lowered	h_{13} (mm)	82
	4.19	Overall length	l_1 (mm)	2570
	4.20	Length to fork face	l_2 (mm)	1350
	4.21	Overall width of truck body	b_1 (mm)	823
	4.22	Fork dimension	S/e/l(mm)	55x230x1220
	4.25	Overall width of fork	b_5 (mm)	685
	4.32	Wheelbase ground distance	m_2 (mm)	27
	4.33	Aisle width, with pallet 1000x1200 crosswise	A_{5t} (mm)	2790
	4.34	Aisle width, with pallet 800x1200 lengthwise	A_{5t} (mm)	2790
	4.35	Turning radius	W_6 (mm)	2290
Performance Data	5.1	Traveling speed, laden/unladen	Km/h	8/9
	5.2	Lifting speed, laden/unladen	m/s	0.025/0.035
	5.3	Lowering speed, laden/ unladen	m/s	0.03/0.03
	5.7	Gradeability, laden/unladen	%	6/8
	5.8	Max. gradeability, laden/unladen	%	8/20
	5.10	Traveling brake		Regenerative brake
Motor	6.1	Driving motor power	kW	2.2
	6.2	Lifting motor power	kW	1.5
	6.4	Battery voltage/rated capacity	V/Ah	24/560(350/420/490/)

	6.5	Battery weight	Kg	559
		Battery dimension (LXWXH)	mm	780X335X625(490/550/595)
	8.4	Noise level at operator's ear, according to DIN12053	dB(A)	70